

Technical Information Model GS-41 SENSORTRON

TO INSTALL SAMPLE COIN OR TOKEN:

- Slide sensor coil to the right and replace plastic chip with coin or token.
- Release sensor coil, making sure sample coin or token is held firmly in place.
- Do not use a 1965 or 1974 quarter as a sample.

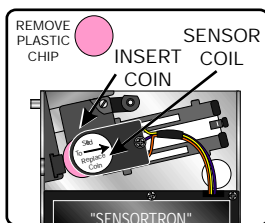

SENSORTRON WIRING:

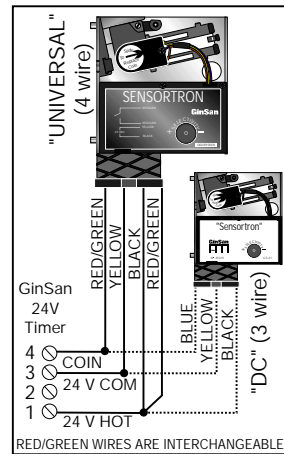

NOTE: YOU MUST HAVE AT LEAST 24 VOLTS AC ACROSS BLACK AND YELLOW WIRES.

SPECIAL INSTRUCTIONS:

- Do Not allow a coin box heater to come in contact with the SENSORTRON.
- To interface a 24 volt mechanical coin counter with a SENSORTRON, order a GS-17 interface, Part Number 77060.

Problem/Symptom:

SENSORTRON accepts unwanted slugs.

Cause:

In 1986 the counter weight was removed from the pendulum damper on the SENSORTRON to correct isolated problems of coins sometimes jamming on the pendulum damper. Counter weights are available through customer service at GinSan Industries in Grand Rapids, MI.

Solution:

Turn the silver colored counter weight with star washer clockwise to attach in the mounting hole of the pendulum damper. (See drawing)

Do Not install Counter Weight unless there is a problem accepting unwanted Slugs or Coins!!!

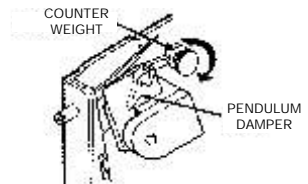

Selectivity Adjustments may be necessary after above procedure is completed.

SELECTIVITY ADJUSTMENTS:

Sensortrons are preset for use with U.S. quarters.



The selectivity control is designed to enable field adjustments for closer coin scrutiny, thereby providing greater rejection of slugs.

- Remove black rubber plug.



- Using small screwdriver, locate adjusting slot on potentiometer (pot.). (Slot is difficult to see in the jelly-like substance.)

- Turn pot. clockwise as far as it will go.
- Turn pot. counterclockwise (a little at a time until it rejects all unwanted coins).



- Replace rubber plug.

When using coins smaller than a quarter (in size), the coin slot opening must be made smaller to prevent jamming.

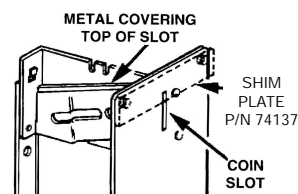

Universal SENSORTRON Wiring Instructions For Various Timers

Note: Red/Green wires are interchangeable.

GinSan Timer (GS-9 110 Volt) to Universal GS-41
Black wire to Terminal #5
Yellow wire to Terminal #7
Red/Green wires to Terminal #4 & #5

GinSan Timer (GS-11 110 Volt) to Universal GS-41
Black wire to Terminal #4
Yellow wire to Terminal #1
Red/Green wires to Terminal #3 & #4

D & S Timer to Universal GS-41
Black wire to 24 Hot(L1)
Yellow wire to 24 Common(L2)
Red/Green wires to 24 Common(L2) & Coin Terminal

Paraplate Timer to Universal GS-41
Black wire to -Coin Switch
Yellow wire to Jumper for 24 V AC
Red/Green wires to +Coin Switch & -Coin Switch

Keltner Timer 24 Volt to Universal GS-41
Black wire to Terminal #2
Yellow wire to Terminal #1
Red/Green wires to Terminals #2 & #4

Parker Timer to Universal GS-41
Black wire to Terminal #1
Yellow wire to Terminal #3
Red/Green wires to Terminals #1 & #4

Dixmor Digital Timer to Universal GS-41
Black wire to 24 V AC Hot (IN)
Yellow wire to 24 V AC Common (IN)
Red/Green wires to Coin Common & Coin Signal

SEE CLEANING INSTRUCTIONS ON PAGE 2

SENSORTRON CLEANING INSTRUCTIONS

The proper care and cleaning of a Sensortron Coin Acceptor can prevent and remedy coin rejection issues. A simple procedure is detailed below.

Place rubbing alcohol in a spray bottle.

Remove these 2 screws with a size "0" square bit, and then clean the chassis and bottom of the kicker foot with rubbing alcohol.

IMPORTANT
Please make sure the contact point of kicker foot and chassis is clean and dry!

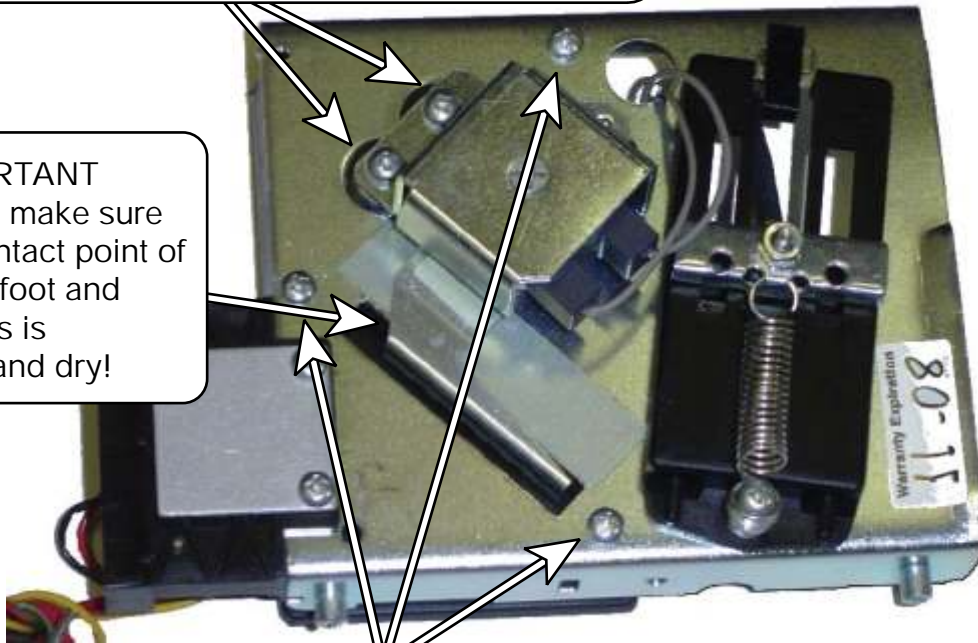

Remove these 3 screws, pull black box forward slightly, and clean the back of the box and chassis with rubbing alcohol and a cotton swab or clean cloth. Spray entire coin path with alcohol and spray out with compressed air